



## LED Red Rear Marker Lamp

#LED50R

www.qvee.com.au

### DESCRIPTION

LED red marker lamp. Features a 10 - 30V multi-volt circuitry to suit a wide range of applications. Comes with black mounting bracket, mounting screws and a pre-wired 300mm twin sheathed cable.

E-Mark approved.



Clear lens when not illuminated

### FEATURES

- Water and dust proof - IP67
- Compact and easily installed
- Multi-volt: 10 - 30 Volt
- ABS housing and polycarbonate lens
- E-Mark approved



### DIMENSIONS

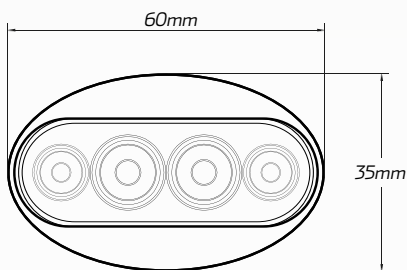

Front

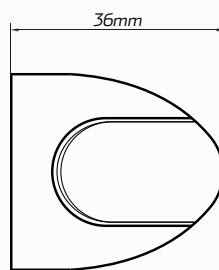

Side

### Wiring Configuration

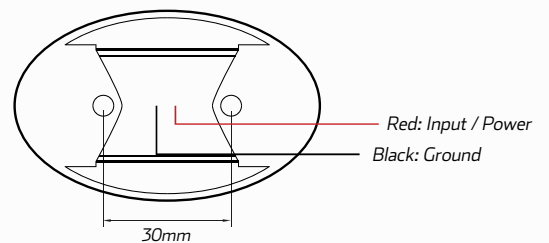

Red: Input / Power  
Black: Ground

\*Dimension measurements include mounting brackets

### TECHNICAL SPECIFICATIONS

<b>Voltage</b>	• Multi-volt 10 - 30 V DC
<b>IP Rating</b>	• IP67 Rated
<b>LED Count</b>	• 4 LED's (Red Coloured)
<b>Estimated Working Life</b>	• 100,000 Hours
<b>Base Material</b>	• ABS

<b>Lens Material</b>	• Polycarbonate
<b>Lens Colour</b>	• Clear unless illuminated
<b>Accessories</b>	• Mounting Bracket • Mounting Screws
<b>Approvals</b>	• E4 E-Mark approved • SAE ISO/TS 16949