



## Heavy Duty Isolator Switch

#SI22010

www.qvee.com.au

### DESCRIPTION

Heavy duty battery isolator switch.

Features a red removable key and a rubber cap.

Key is only removable in the OFF position to prevent accidental & unauthorized ignition. 300A continuous current.

### FEATURES

- Suitable for 12/24 Volt applications
- 300A @ 12V / 150A @ 24V continuous current
- 1000A intermittent @ 12 Volt
- Weatherproof rubber cap. Applicable when switch is not in use
- Bronze tin plated brass terminals for optimal connection



#### Comprises:

- Red removable key
- Weatherproof rubber cap (removable)
- Lock nuts & washers

### TECHNICAL SPECIFICATIONS

#### DIMENSIONS

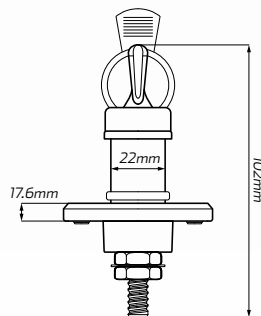
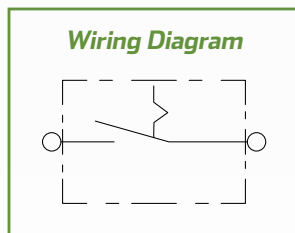
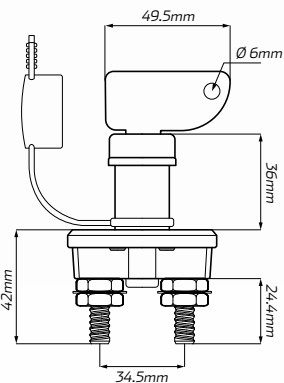
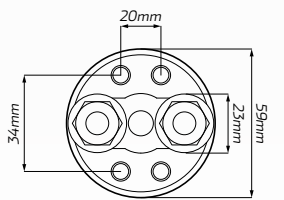

|                      |  |
|----------------------|--|
| Voltage              | • Suitable for 12/24 Volt applications |
| Continuous Current   | • 300A @ 12V, 150A @ 24V               |
| Intermittent Current | • 1000A @ 12V, 500A @ 24V              |
| Key Material         | • Plastic, rubber base                 |
| Key Colour           | • Red with black rubber base           |
| Switch Material      | • Plastic                              |
| Switch Colour        | • Black                                |
| Terminal Material    | • Bronze tin plated brass              |
| Terminal Size        | • M10 x 0.75                           |
| Dimensions           | • 59mm W x 102mm H                     |