



Cole Hersee Co.

Lever Type Dual Battery Isolator Switch

#75912B

www.colehersee.com.au



DESCRIPTION

DPST on/off dual battery isolator switch with indexing post.

6-36V, 125A continuous x 2, 750A intermittent x 2.

Has 4 battery studs. This switch can be used to switch positive and negative at the same time or for 2 separate circuits. Features silver contacts with chrome lever, weather resistant O'ring seal on mounting shaft. 3/4" mounting stem.

FEATURES

- Disconnects the battery and the alternator or generator field
- Controls two systems, or it can be used to disconnect both positive and negative of the same circuits
- Silver contacts. chrome lever
- Indexing pin aligns switch and prevents rotation
- Suits panel thickness to 6.5mm
- Weather resistant, O-ring sealed
- Mounting stem 3/4" - 24 thread, L 13mm
- 4 x battery stud 3/8" - 24

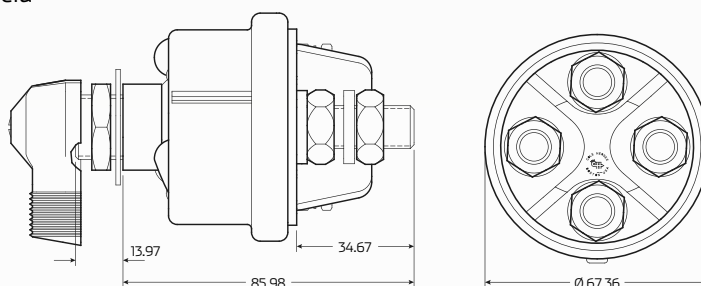

*All measurements are in mm

TECHNICAL SPECIFICATIONS

| | | | |
|----------------------------|-------------------------|------------------------------|-------------------------------------|
| Voltage | • 6 - 36V multi-volt | Housing Material | • Steel plated casing, chrome lever |
| Maximum Amperage | • 750A Intermittent x 2 | Stud Size | • Battery studs: 3/8" - 24 |
| Continuous Amperage | • 125A continuous x 2 | Stud Torque | • 4.4 to 7.4 ft lbs (6-10 Nm) |
| Configuration | • DPST | Operating Temperature | • -40°C to 85°C |
| Dimensions | • 110mm x 67mm Ø | Mounting Stem | • 3/4" - 24 thread, L 13mm |
| Contact Material | • Silver contacts | Weatherproof | • Yes, O-ring sealed |