

## LED Red / Amber Marker Lamp

#LED50AR

www.qvee.com.au

### DESCRIPTION

LED red/amber marker lamp. Features a 10 - 30V multi-volt circuitry to suit a wide range of applications. Comes with black mounting bracket, mounting screws and a pre-wired 300mm twin sheathed cable.

E-Mark approved.



Clear lens when not illuminated

### FEATURES

- Water and dust proof - IP67
- Compact and easily installed
- Multi-volt: 10 - 30 Volt
- ABS housing and polycarbonate lens
- E-Mark approved



### DIMENSIONS

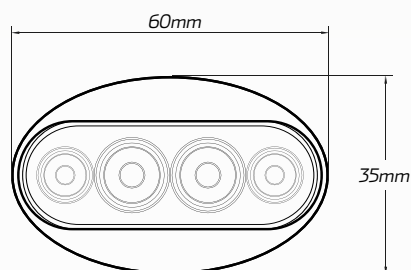

Front

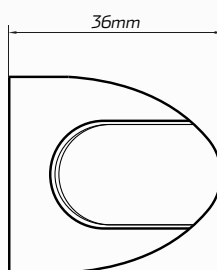

Side

\*Dimension measurements include mounting brackets

### Wiring Configuration

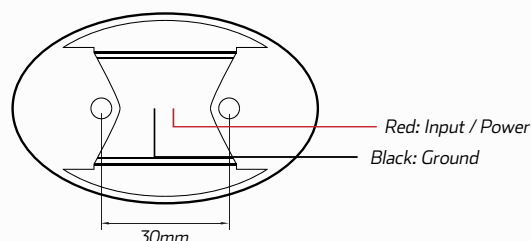

### TECHNICAL SPECIFICATIONS

Voltage	• Multi-volt 10 - 30 V DC
IP Rating	• IP67 Rated
LED Count	• 4 LED's (Red Coloured)
Estimated Working Life	• 100,000 Hours
Base Material	• ABS

Lens Material	• Polycarbonate
Lens Colour	• Clear unless illuminated
Accessories	• Mounting Bracket • Mounting Screws
Approvals	• E4 E-Mark Approved • SAE ISO/TS 16949