

## Small Toyota Style Worklight ON/OFF Switch

#QVSWPR2BBL

www.qvee.com.au

### DESCRIPTION

The QVSWPR2B push button ON/OFF switches are designed as a direct replacement for Toyota Prado and 200 series Landcruisers. Comes with wiring harness and has a Blue LED illumination. Great look for any fit out.



### TECHNICAL SPECIFICATIONS

|                               |  |
|-------------------------------|--|
| <b>Flame Retardant Rating</b> | • UL94 - V0  |
| <b>Voltage Input</b>          | • 12V Input  |
| <b>Amperage Rating</b>        | • 3 A  |
| <b>LED Current Draw</b>       | • Less than 0.25 W   |
| <b>LED Colour</b>             | • Blue LED Illumination  |
| <b>Applications</b>           | • 4WD's, RV's, ATV's, Cars, Trucks, Agricultural Machinery, Earthmoving Equipment. |

### DIMENSIONS

#### SIDE

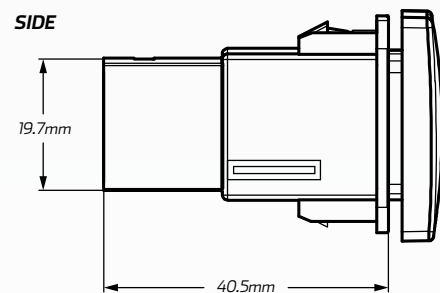

### MODEL

- 2016 Hilux
- 2015 - Current Tundra
- 2010 - Current Prado 150
- 2008 - Current 200 Series Landcruiser

#### FRONT

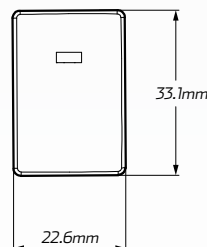

#### TOP

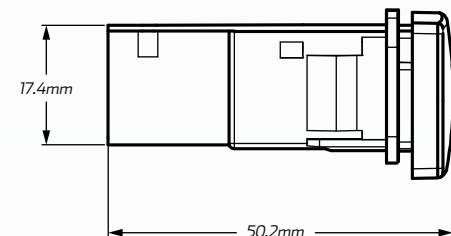

### WIRING HARNESS

Switch Activation Input: Green

Output: Red

Backlight Input: Red

Ground: Black

