

## Small Toyota Style Front Diff Lock ON/OFF Switch

#QVSWPR8BBL

www.qvee.com.au

### DESCRIPTION

The QVSWPR8B push button ON/OFF switches are designed as a direct replacement for Toyota Prado and 200 series Landcruisers. Comes with wiring harness and has a Blue LED illumination. Great look for any fit out.



### TECHNICAL SPECIFICATIONS

<b>Flame Retardant Rating</b>	• UL94 - V0
<b>Voltage Input</b>	• 12V Input
<b>Amperage Rating</b>	• 3 A
<b>LED Current Draw</b>	• Less than 0.25 W
<b>LED Colour</b>	• Blue LED Illumination
<b>Applications</b>	• 4WD's, RV's, ATV's, Cars, Trucks, Agricultural Machinery, Earthmoving Equipment.

### DIMENSIONS

#### SIDE

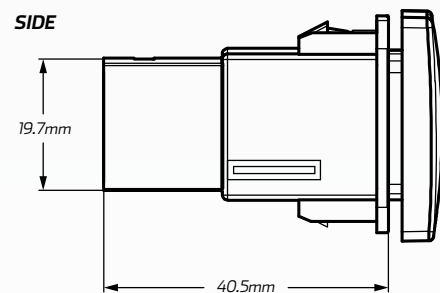

### MODEL

- 2016 Hilux
- 2015 - Current Tundra
- 2010 - Current Prado 150
- 2008 - Current 200 Series Landcruiser

#### FRONT

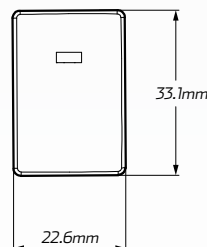

#### TOP

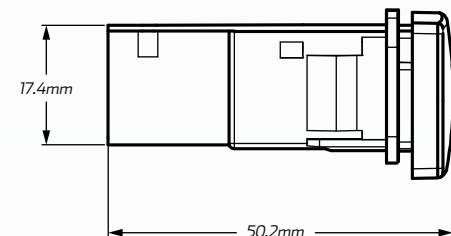

### WIRING HARNESS

Switch Activation Input: Green

Output: Red

Backlight Input: Red

Ground: Black

