

Spade Terminals

Sold in Pack of 100

www.qvee.com.au



DESCRIPTION

QVEE's crimp terminals are all copper sleeved. They are manufactured to the highest standards and conform to UL specifications. Our premium copper sleeve range (also known as "double grip") are funnel entry to aid in the speed of termination and prevent wire strands folding back.

Material	• Brass tin plated with vinyl insulation
Insulation Colour	Maximum Electrical Rating
Red – 3mm Cable	• 75°C, 300 Volts, 10 Amp Max
Blue – 4mm Cable	• 75°C, 300 Volts, 15 Amp Max
Yellow – 5-6mm Cable	• 75°C, 300 Volts, 24 Amp Max

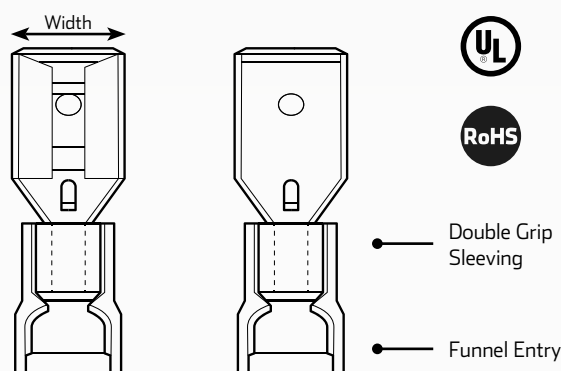

TECHNICAL SPECIFICATIONS

Male Spade Terminals

Part No.	Insulation Colour	Spade Width	Auto Cable Size	Description
CT14/100	• Red	• 6.3mm	• 3mm (1.13mm ²)	• Red male spade terminal with 6.3mm spade, suits 3mm automotive cable
CT33/100	• Blue	• 6.3mm	• 4mm (1.84mm ²)	• Blue male spade terminal with 6.3mm spade, suits 4mm automotive cable
CT87/100	• Yellow	• 6.3mm	• 5-6mm (2.90-4.59mm ²)	• Yellow male spade terminal with 6.3mm spade, suits 5-6mm automotive cable

Female Spade Terminals

Part No.	Insulation Colour	Spade Width	Auto Cable Size	Description
CT52/100	• Red	• 2.8mm	• 3mm (1.13mm ²)	• Red male spade terminal with 2.8mm spade, suits 3mm automotive cable
CT13/100	• Red	• 4.8mm		• Red male spade terminal with 4.8mm spade, suits 3mm automotive cable
CT12/100	• Red	• 6.3mm		• Red male spade terminal with 6.3mm spade, suits 3mm automotive cable
CT62/100	• Blue	• 4.8mm	• 4mm (1.84mm ²)	• Blue male spade terminal with 4.8mm spade, suits 4mm automotive cable
CT32/100	• Blue	• 6.3mm		• Blue male spade terminal with 6.3mm spade, suits 4mm automotive cable
CT58/100	• Blue	• 8.0mm		• Blue male spade terminal with 8.0mm spade, suits 4mm automotive cable
CT50/100	• Yellow	• 6.3mm	• 5-6mm (2.90-4.59mm ²)	• Yellow male spade terminal with 6.3mm spade, suits 5-6mm automotive cable
CT51/100	• Yellow	• 9.5mm		• Yellow male spade terminal with 9.5mm spade, suits 5-6mm automotive cable